

1 Changing source, volume and brightness

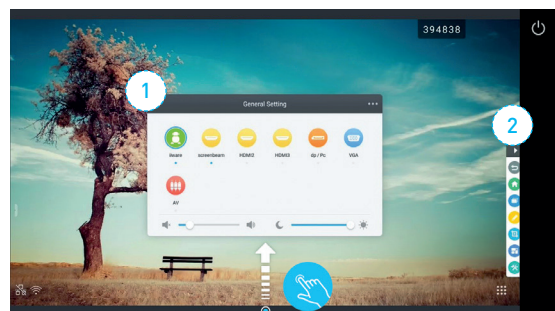

To call-up the settings pop-up, place your finger or stylus at the bottom of the screen in the middle and swipe upwards.

Tap outside the settings pop-up to close the pop-up.

2 Side slide toolbar and Home screen icons



Tap the grey arrow icon on the left or right of the screen to call-up the slide toolbar.



Back
Go back to the previous screen or application.



Home
Go to the home screen.



Annotate
Make annotations on what is currently shown on the display.



Zoom
Pause/freeze the screen. Tap the red cross icon to continue.



Cut
Make copy of what is currently displayed on the screen.



Apps
Select one of the available apps.

3 Applications

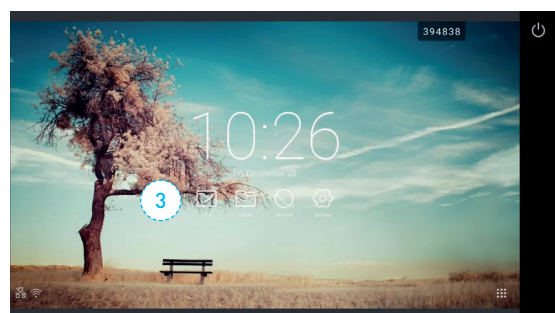

iiWare (Android OS)

03 series iiyama screens equipped with iiWare 8.0 (Android OS) feature different applications for collaboration and the sharing of content. Among others iiWare supports playback of presentations, high-resolution video and almost any other type of content from a USB drive, online or internal memory.



Note
Note is the digital whiteboard app for annotations. You can write, draw, sketch and save your notes directly to the internal memory, Cloud Drive, USB or share them with your colleagues via a QR code.
Please see 'Making notes' for more info on how to use Note.



Web Browser
Tap the icon to start the Browser. Tap on the address field to call-up the onscreen keyboard and enter the URL. Tap the Enter button (a) on the keyboard to surf to a URL. To close the browser tap the three dots (b) in the top right corner of the browser and select close.



Finder
The Finder shows you all the files and folders that are on the display's internal memory, USB flash drive and the available Cloud drives. Tap to select the location and view the files/folders.

394838

6-digit WiFi code

This code is used for the mobile screen sharing application. Tap once to show the WiFi network name. Tap and hold the code to move the code around. For details go to step 5.

Application overview

Open application overview.
See applications for more info.

Network Status

This icon shows the status of the network connection. *

WiFi Status

This icon shows the status of the WiFi connection. *

Finder - to open a file tap on the file icon.

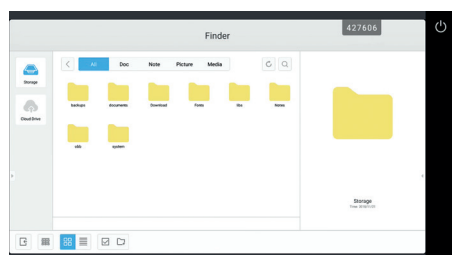

View

View as list or as folders

Select file/folder to edit

Filter on file/media ty

All

Doc

Note

Picture

Media

Options (delete, rename, copy, duplicate or send file/folder)

New folder

Search

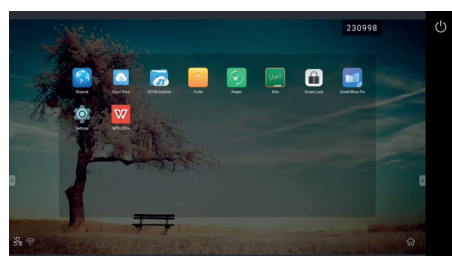

Keeper
Use Keeper to clean the memory and delete the cache of the display. [See GDPR for more info].

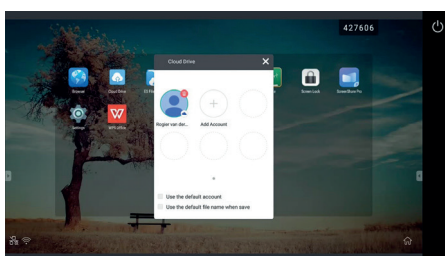

Cloud Drive
The Cloud Drive shows all available cloud drives. You can add a Microsoft OneDrive or a Google Cloud drive. To delete a Cloud Drive, tap and hold the icon until a red trash can icon appears top right. Tap the trash can icon to remove the account.

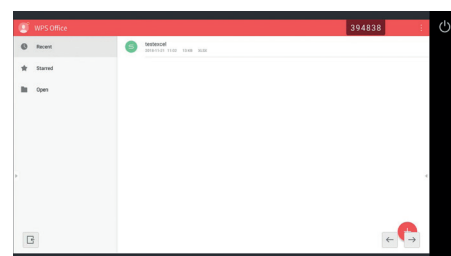

WPS Office
WPS Office is the application for Microsoft Office files.

4 Function 4 Making, sharing and saving of notes

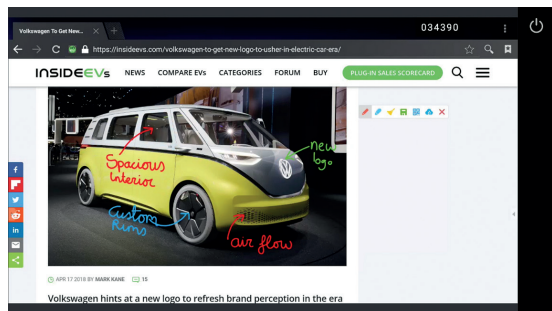

There are various ways of making, sharing and saving your annotations. Here's a quick overview of the options.

Making annotations in applications and on screen

Open the side slide toolbar and select the pen icon.



Pen
Double sided pen to define 2 different colours and use simultaneously. Available for Note app only.



Swipe
Clears all annotations.



Upload
Save your notes to the cloud drive.



Marker
Tap to change highlight color.



Save
Save your notes.



QR
Share your notes via QR code.

Making annotations with Note

Important functions in Note:



Menu
New, Open, Save, Import, Export (JPG or PDF), Cloud storage (Save) and Background.



Arrow
Select parts of your annotations with your finger or stylus to edit.



Eraser
Select the area you want to erase. Use your palm to select the block eraser.



Shapes
Tap to use the last selected shape. Hold to select different shapes.



Add page



Close



Pen
To change pen type, color and size tap and hold pen icon.



Swipe
Clears all annotations on the page.



Undo & redo
Undo (back) or redo (forward) the last change.



Previous/Next page

A complete video walkthrough of all the functions in Note can be found on iiyama's YouTube channel.

Saving files

When you click on save, the file manager app will be shown. Select the internal memory, cloud drive or USB drive to save your files and (re)name your file.

Saving on a cloud drive (OneDrive/Google Drive/Dropbox)

When saving files select the cloud save icon or the cloud drive in Finder.

To save on Dropbox, save your notes to the internal memory. Use the WPS applications to connect to your Dropbox and copy/move the files to Dropbox.

USB flash drive

To open and save your content on a USB flash drive, plug your USB drive in a USB port on the right side of the display. Use the File Manager or the WPS application to access your USB.

In Note click Open, Save or Export. The file manager pop-up will be shown to select your USB drive.



QR code sharing

Annotation can also be shared via a QR code. Tap the QR code icon [a] to display a custom QR code. To download the notes, users need to be connected to the same network as the display.

5 WiFi module for screen sharing / -Screenshare Pro

Share, stream and edit content from any device on screen and transform your team meetings or lessons into an easy, fast and seamless interactive session thanks to the WiFi module (OWM001) included as standard and the ScreenSharePro app.

1. Connect with the same network as the display.
2. Download the Screenshare Pro software for your device (Mac, Windows, iOS or Android) from www.iiyama.com/connect
3. Enter the 6-digit access code on screen in the application.

Network name:

Password network:

Note: The WiFi module can accept a maximum of 4 connections. When a fifth device connects, the first connection gets disconnected.

7 Transform your display into a stand-alone solution with the PC slot*.

It comes equipped with a powerful Intel® Core™ i5 processor with integrated Ultra HD graphics and a fast SSD drive.

* Not suited for OPS Slot PC's. Sold separately.

6 GDPR - Deleting Personal Data after use

Please make sure to delete all of your data when leaving the room.

To do so please follow these steps:

1. Use Keeper (see image 10) to clean memory and clear cache.
2. Delete all files and images you stored on the internal memory of the display via the Finder application.
3. Remove your USB flash drive.
3. Make sure you disconnect/remove any personal cloud drives that you have added.

To delete a cloud drive, see function 3 description.

Trouble shooting

1. **Wifi icon.** If the WiFi is not available tap the WiFi icon to access the WiFi settings. and turn the Wifi On/ off.

2. **Network icon.** If the LAN network is not available, tap the network icon to access the network settings and turn the network function on.

If you are experiencing problems with the display please contact the IT department:

IT Support / Service contact details sticker